

# COMMERCIAL POOL HEATING

ELECTROHEAT PRO SERIES HEAT PUMP

Electr  Heat PRO

[www.waterco.com.my](http://www.waterco.com.my)

**WATERCO**  
water, the liquid of life

Air source heat pump is the innovative heating equipment, which emphasizes on conservation in energy generation and environmental friendly technology. It is a highly efficient machinery in absorbing and transferring energy.

Its operation principle is based on the Reversed Carnot Cycle. By continuously absorbing the surrounding air, the Electroheat Pro Heat Pump is able to conduct heating at a fast rate while ensuring energy conservation and environmental-friendliness.

The high efficiency of Electroheat Pro Heat Pump is coupled with low operating cost. Its power consumption is only a quarter to that of electrical water heater.

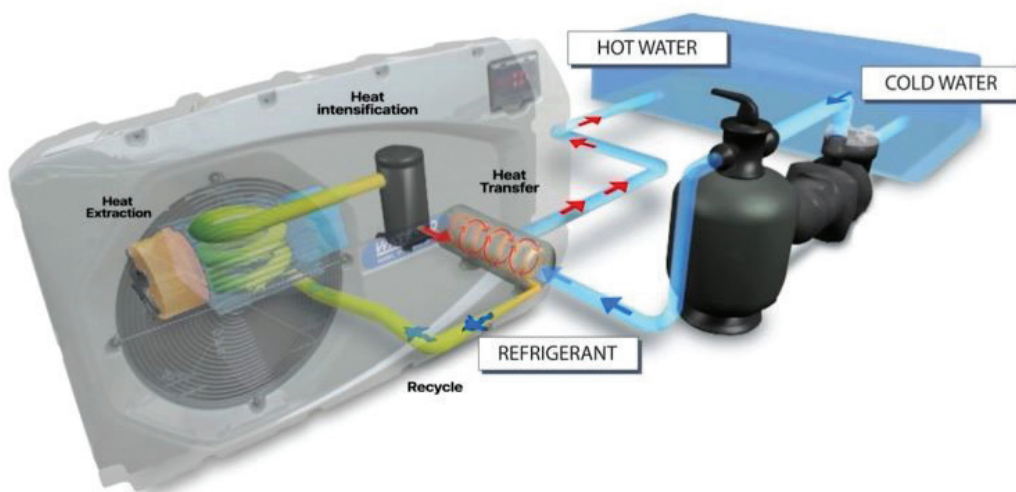

# Electr Heat PRO 60kW

The **Electroheat PRO 60** inverter pool heat pump which is a high-performance, energy efficient pool heat pump designed for commercial applications. It's known for its powerful heating capacity and innovative inverter technology, which allows for precise temperature control and significant energy savings.

## Key Features:

- **Inverter Technology:** This advanced technology allows the heat pump to adjust its power output based on the required heating load, optimizing energy consumption and reducing operating costs.
- Heating, Cooling and Auto mode selection
- **Quiet Operation:** The heat pump operates quietly, minimising disturbances to pool users and surrounding areas.
- **High Heating Capacity:** The PRO 60 is capable of efficiently heating and cooling large commercial pools, ensuring optimal water temperatures year-round.
- **Energy Efficiency:** The heat pump's advanced design and inverter technology contribute to its high coefficient of performance (COP), resulting in reduced energy consumption and lower electricity bills.
- **Durable Construction:** The PRO 60 is built with high-quality materials, including a corrosion-resistant titanium heat exchanger and aluminium alloy casing ensuring long-lasting performance.
- **Easy Installation and Maintenance:** The unit is designed for easy installation and maintenance, reducing downtime and increasing convenience.



Titanium Heat Exchangers



R32 Refrigerant



Twin Horizontal Fan

Specifications		
Model Number	PRO60	
Power Mode	Heating capacity (kW)	60.0
Perfect Mode	Heating capacity (kW)	48.5
	COP range	7.5-15.1
	Average COP at 50% Speed	12.0
<b>Performance Condition: Air 15°C/ Water 26°C/ Humid. 70%</b>		
Power Mode	Heating capacity (kW)	42.0
Perfect Mode	Heating capacity (kW)	34.0
	COP range	5.6-8.1
	Average COP at 50% Speed	7.5
<b>Performance Condition: Air 35°C/ Water 28°C/ Humid. 80%</b>		
Cooling capacity (kW)		25.0
<b>Technical Specifications</b>		
Rated input power (kW)		1.88-7.50
Rated input current (A)		2.72-10.87
Sound level at 1m dB(A)		51.0-59.0
Sound level 50% at 1m dB(A)		53
Sound level at 10m dB(A)		30.0-39.0
Operating air temperature (°C)		-20-43°C
Compressor		Mitsubishi DC Inverter Compressor
Heat exchanger		Twisted Titanium Heat Exchanger
Fan direction		2 X Horizontal
Power supply		400-415V/ 3 Ph/ 50Hz
Water Flow Rate (LPM)		330 ~ 400
Water connection (mm)		65mm slip
Net dimension LxWxH (mm)		460 X 1545 X 1630
Refrigerant		R32 - 4800 grams

## Clearance

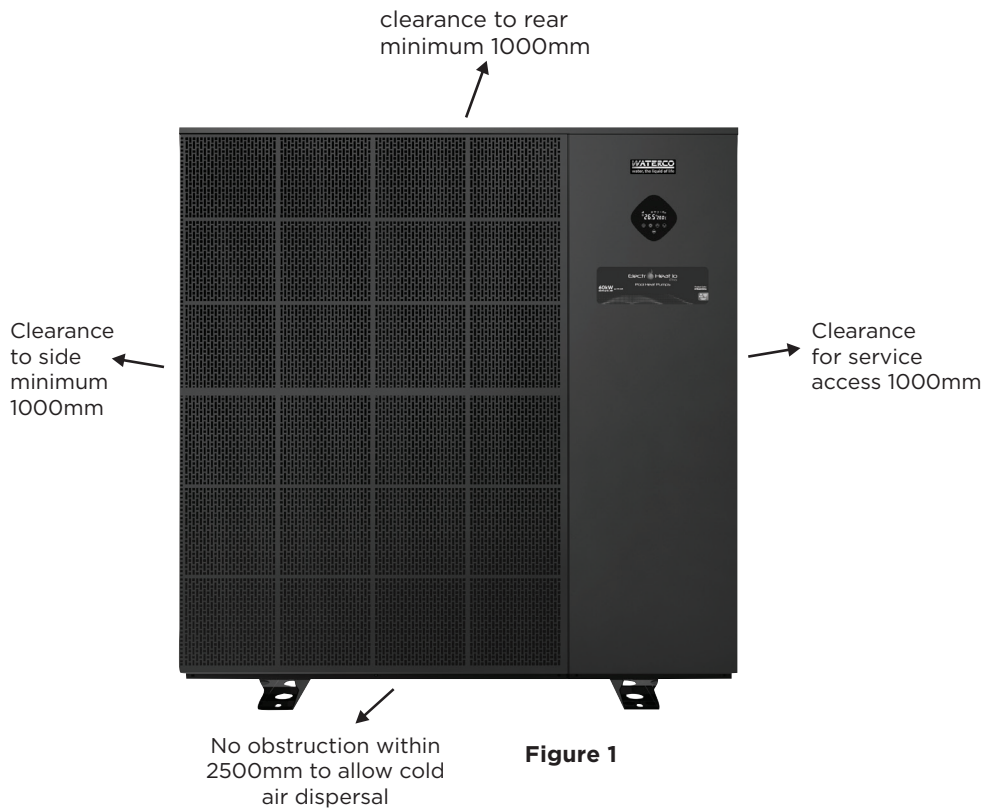

## Dimension

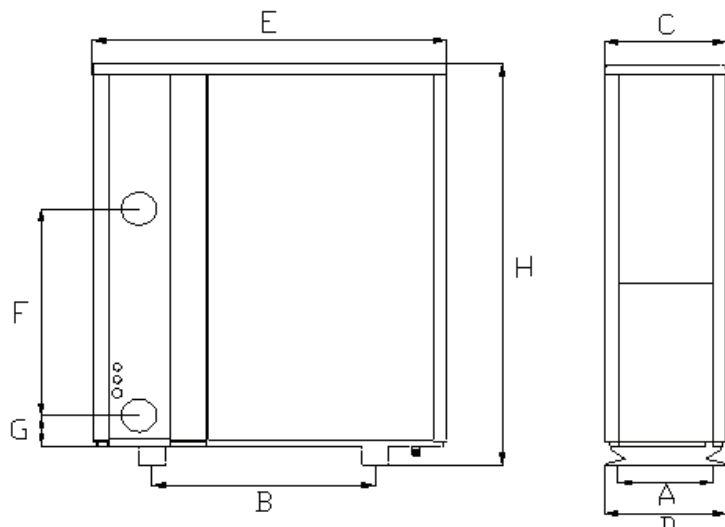

Size(mm) / Name	A	B	C	D	E	F	G	H
Model								
IMC60WAT	391	1055	458	459	1545	840	123	1630

# Electr Heat PRO 110

The **Electroheat PRO 110** heat pump has been designed to deliver efficient cost effective large pool heating in an easy to operate and install package.

- Titanium twisted coil exchangers for maximum heat transfer
- Blue fin dipped evaporators for enhanced heat absorption
- Twin high performance 12 HP scroll compressors
- Twin fans for maximum airflow
- Automatic hot gas de-icing for cold climates
- Easy to connect single in / out 80mm water connections
- Easy cable entry and electrical connection access
- Integral flow switch protecting equipment from operation when no flow is detected
- Noise emission: 58 dBA@ 3 metres

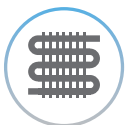

Aluminium Evaporator



Electronically controlled temperature



Scroll Compressors



Titanium heat exchangers



R410A Refrigerant



Energy-saving heating solution



Delayed compressor operation

Specifications	
<b>Model Number</b>	<b>PRO110</b>
Nominal Heating Cooling Capacity*	
Power Output Heat (27/27/80)	110 kW (376,000 BTU)
Power Output Heat (24/27/70)	105 kW (358,000 BTU)
Power Output Heat (15/27/70)	85 kW (290,500 BTU)
Power Output Heat (-5/27/63)	46 kW (157,900 BTU)
Power Output Cool (35/27/70)	60 kW (205,800 BTU)
Coefficient of Performance@27/27/80 (COP)	5.36
Compressor	(2 x) 12 HP
<b>Water Flow &amp; Plumbing Characteristics</b>	
Water Bypass Type	Ext. field install
Min/Max Water Flow Rate (LPM)	650 - 750
Min/Max Water Inlet Temperature (°C)	14 - 40
Plumbing Connection Size (Slip) (mm)	80
<b>Electrical Characteristics</b>	
50Hz Dual Rated Supply Voltage (VAC)	380 - 415
Supply Voltage Phase	3
Max HACR Breaker or Fuse (AMP)	60
Average unit input current (AMP)	40
Maximum unit input current (AMP)	54
Normal power consumption (kW)	16.6
Max. Fan Speed (RPM)	900
Fan Motor	Axial
Fan Full Load Amp (FLA) each	1.4
Air Flow (CFM) each	9500/ 5613
Fan Diameter (mm)	630
Min/Max Air Inlet Temperature (°C)	>0/ 40
<b>Refrigerant Characteristics</b>	
Refrigerant Type	R-410A
Initial Factory Refrigerant Charge (kg)	(2 x) 5.5
Evaporator	Hydrophilic aluminium
Heat Exchanger	Titanium in PVC
Expansion system	(2 x) Expansion valve
<b>Physical Characteristics</b>	
Cabinet Construction	Powder coat steel
Colour	Black
Weight (kg)	530
Dimensions (W x L x H) (mm)	900 x 2000 x 1880
<b>Noise Emission Characteristics</b>	
Noise Emission (dBA)	58@3 m

\*(27/27/80) = Air Temp: 27°C/ Water Temp 27 °C/ Humidity 80%

## Dimensions

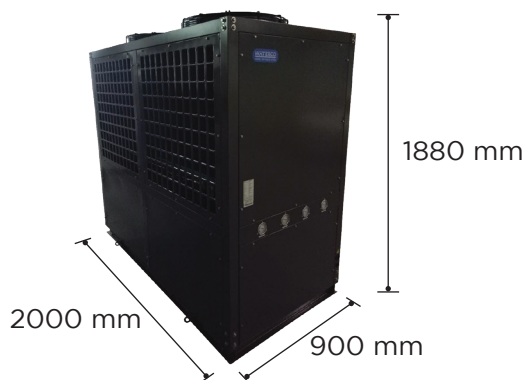

## Clearance



# Electr Heat PRO 150 & 250

The new generation **Electroheat PRO 150 and 250** series of heat pumps is the latest advancement in commercial size swimming pool heating. The heat pumps have been designed to deliver efficient and cost effective large pool heating in an easy to operate and install package.

- Hydrophilic aluminium evaporator
- Electronically controlled temperature management
- Hermetic scroll compressors
- Titanium heat exchangers
- R410A Refrigerant
- Energy-saving heating solution
- Delayed compressor operation as safety feature

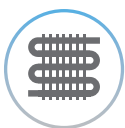

Aluminium Evaporator



Electronically controlled temperature



Scroll Compressors



Titanium heat exchangers



R410A Refrigerant



Energy-saving heating solution



Delayed compressor operation



## Clearance

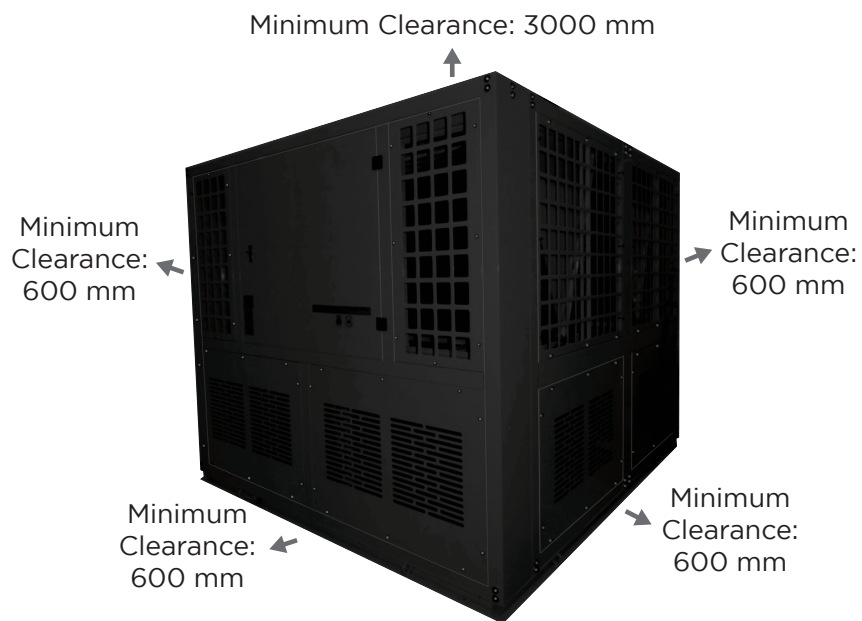
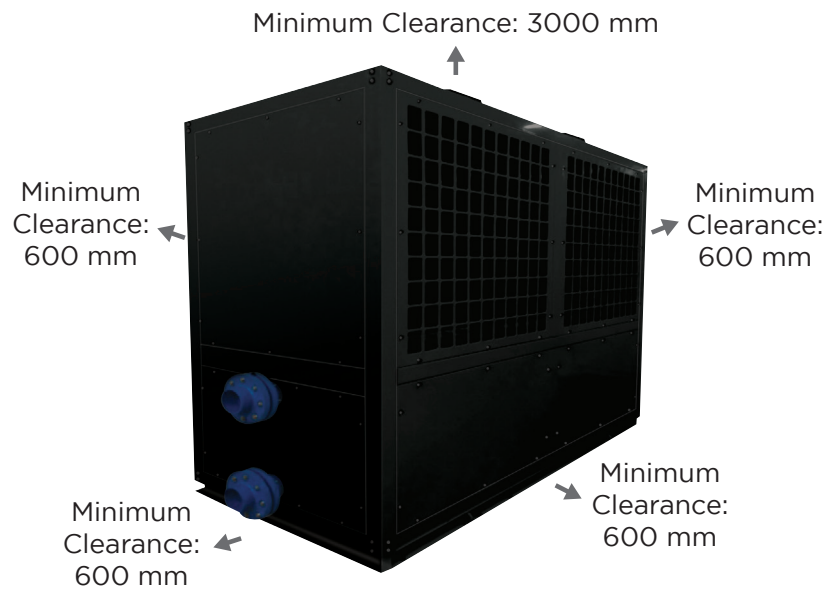

Specifications				
Model			Electroheat PRO 150	Electroheat PRO 250
Air 24°C/Water 27°C (Nominal)	Heating Capacity	kW	150 (511,500 BTU)	250 (852,500 BTU)
	Heating Input	kW	29	49
	COP		5.17	5.10
Air 27°C/Water 27°C	Heating Capacity	kW	157 (537,000 BTU)	262 (895,000 BTU)
	Heating Input	kW	29	50
	COP		5.41	5.24
Air 15°C/Water 27°C	Heating Capacity	kW	112 (384,500 BTU)	191 (652,500 BTU)
	Heating Input	kW	27	47
	COP		4.14	4.06
Air -5°C/Water 27°C	Heating Capacity	kW	66 (225,500 BTU)	110 (375,500 BTU)
	Heating Input	kW	23	39
	COP		2.86	2.82
Air -15°C/Water 27°C	Heating Capacity	kW	45 (153,000 BTU)	75 (255,500 BTU)
	Heating Input	kW	20	35
	COP		2.25	2.14
Air 35°C/Water 27°C	Cooling Capacity	kW	74 (255,500 BTU)	122 (418,000 BTU)
	Cooling Input	kW	31	47
	COP		2.38	2.59
Max. Current		A	80	132
Power Supply		V/Ph/Hz	380-415V/3Ph/50Hz	380-415V/3Ph/50Hz
Compressor	Type		Scroll	Scroll
	Quantity	pcs	2	4
	Capacity	kW	44	37
Refrigerant Type	Type		R410a	R410a
	Quantity	kg	6.5 x 2	5.5 x 4
Evaporator	Type		Hydrophilic aluminium/ φ9.52 inner groove tube	Hydrophilic aluminium/ φ9.52 inner groove tube
	Number of rows		3	2
	Fin spacing	mm	1.8	1.8
Fan motor	Speed		2-speed	2-speed
	Quantity	pcs	2	4
Water Flow Switch			Built-in	Built-in
Controller			Multi System Controller with Large LCD Monitor	Multi System Controller with Large LCD Monitor
Noise		dB(A)	60	65
Water Connection		mm	90 (Metric)	110 (Metric)
Water Flow Rate	Minimum	L/h	25,800	43,000
	Maximum	L/h	65,000	110,000
Dimension	L-W-H	mm	2000-980-1970	2000-2160-2000
Weight	Net Weight	kg	600	1,020

## Warranty

Heat Pump Parts	Domestic	Commercial
Compressor	3 years	1 year
Titanium Heat Exchanger	10 years	1 year
All other components	2 years	1 year



# **WATERCO**

**water, the liquid of life**

Waterco pioneers reliable solutions for healthy, safe water environments, which are used in residential, commercial and industrial applications in over 40 countries.

Established in 1981, it has since become a global brand recognised for designing and manufacturing filtration and sanitisation innovations for the swimming pool, spa, aquaculture, and water purification sectors.



## CONTACT WATERCO

Waterco's head office is situated in Sydney, Australia with international offices, manufacturing plants and warehouses located in Australia, New Zealand, Malaysia, Indonesia, Singapore, China, the US, Canada, and the UK.

### OFFICES - AUSTRALIA

NSW - Sydney (Head Office)  
Tel: +61 2 9898 8686  
QLD - Brisbane  
Tel: +61 7 3299 9900  
VIC/TAS - Melbourne  
Tel: +61 3 9764 1211  
WA - Perth  
Tel: +61 8 9273 1900  
SA/NT - Adelaide  
Tel: +61 8 8244 6000  
ACT Distribution  
Tel: +61 2 6280 6476

### OFFICES - OVERSEAS

Waterco (Europe) Limited  
Sittingbourne, Kent. UK  
Tel: +44 (0) 1795 521 733  
Waterco (USA) Inc  
Augusta, Georgia, USA  
Tel: +1 706 793 7291  
Waterco Canada  
Boucherville, Quebec,  
Canada  
Tel: +1 450 748 1421  
Waterco (NZ) Limited  
Auckland, New Zealand  
Tel: +64 9 525 7570  
Waterco (C) Limited  
Guangzhou, China  
Tel: +86 20 3222 2180

Waterco (Far East) Sdn Bhd  
Selangor, Malaysia  
Tel: +60 3 6145 6000  
PT Waterco Indonesia  
Jakarta, Indonesia  
Tel: +62 21 4585 1481  
Waterco International Pte  
Ltd  
Midview City, Singapore  
Ph: +65 6344 2378  
Waterco Vietnam Company  
Limited  
Ho Chi Minh City, Vietnam  
Tel: +84 28 3622 7780

**DISTRIBUTED BY:**

